

7083 031-00

UWT 1682

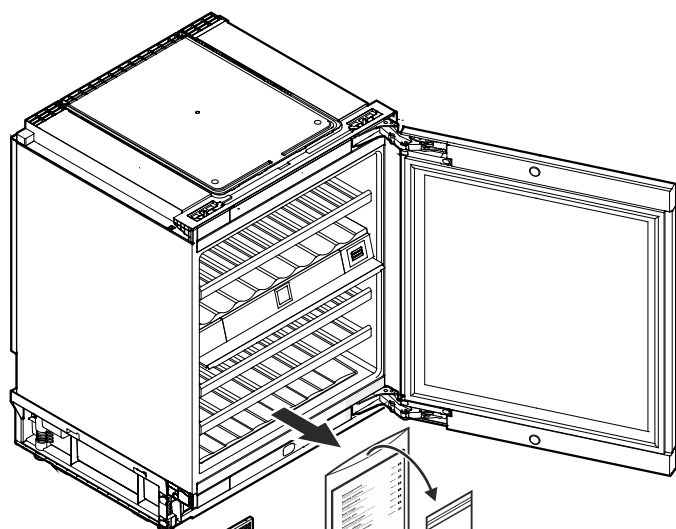

Supplied accessories

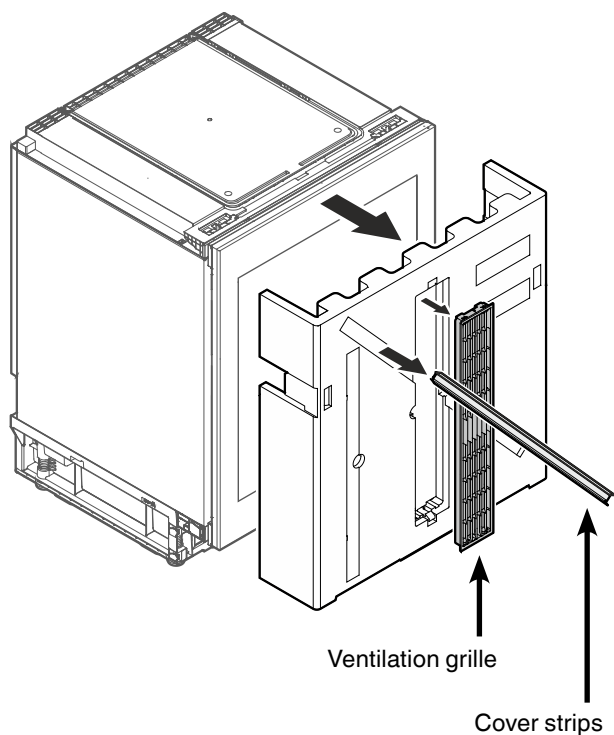

- Dust filter
- Foam moulding for ventilation duct in appliance plinth
- Accompanying documents
- Retaining screws for installation
- Spanner to adjust the height of the appliance

Mounting the dust filter

The supplied dust filter prevents that dirt enters the motor compartment, reducing the refrigeration performance. Therefore always install the dust filter.

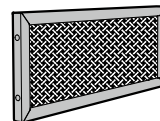

Remove the protective film from the dust filter.

Insert the filter **at the bottom** and click into place **at the top**.

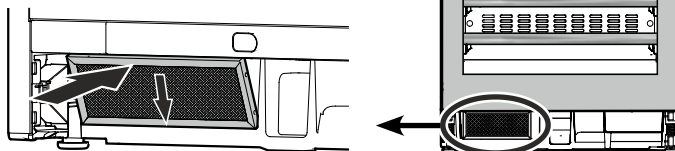

Appliance venting

The required air flow is directed through the plinth.

It is important to use the provided ventilation grille for the ventilation opening.

Cut-out section in the plinth panel

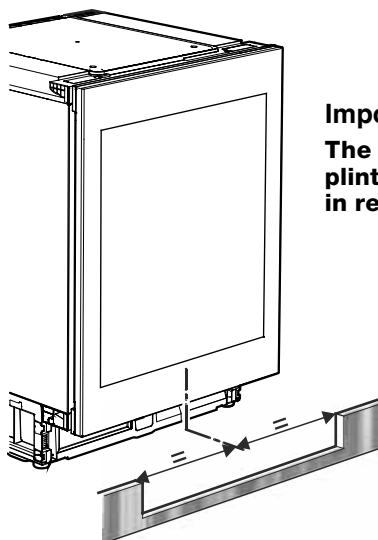
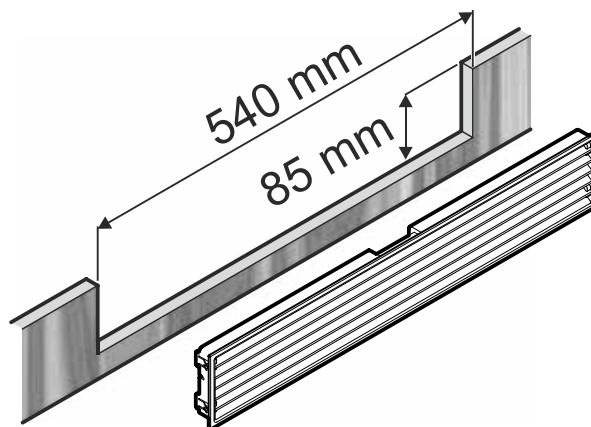

Important

The cut-out section in the plinth panel must be centred in relation to the appliance.

Appliance dimensions

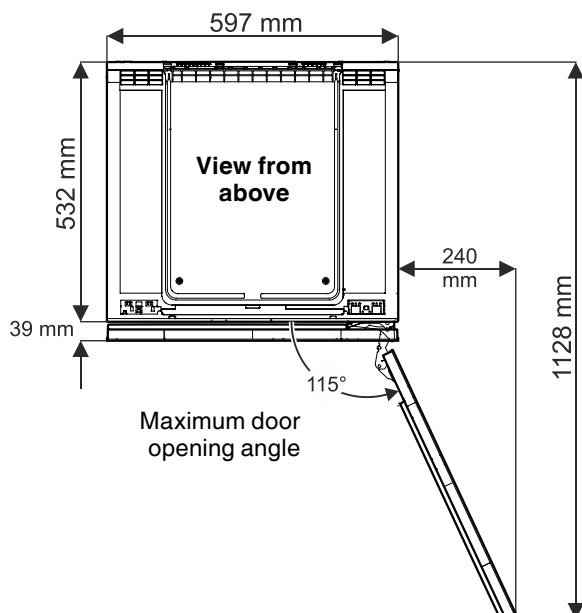

Side view

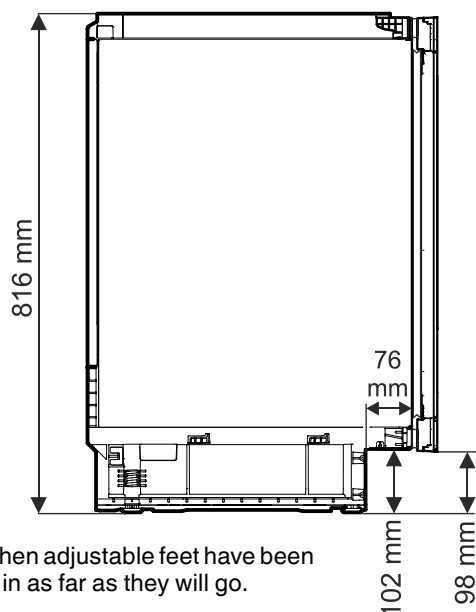

Height when adjustable feet have been screwed in as far as they will go.

Maximum height adjustment = 50 mm

Dimensions of appliance door

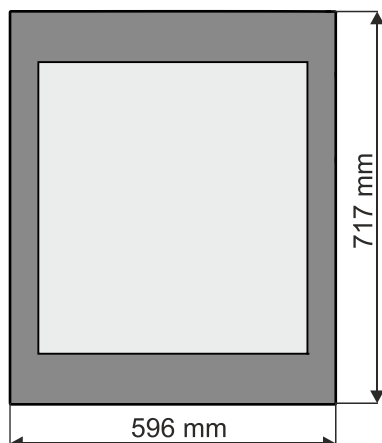

Installation dimensions

Important

In order to avoid any problems when installing the appliance and to avoid damage to the appliance, the following conditions must be complied with.

The floor on which the appliance stands must be horizontal and level.

The kitchen unit must be aligned horizontally and vertically.

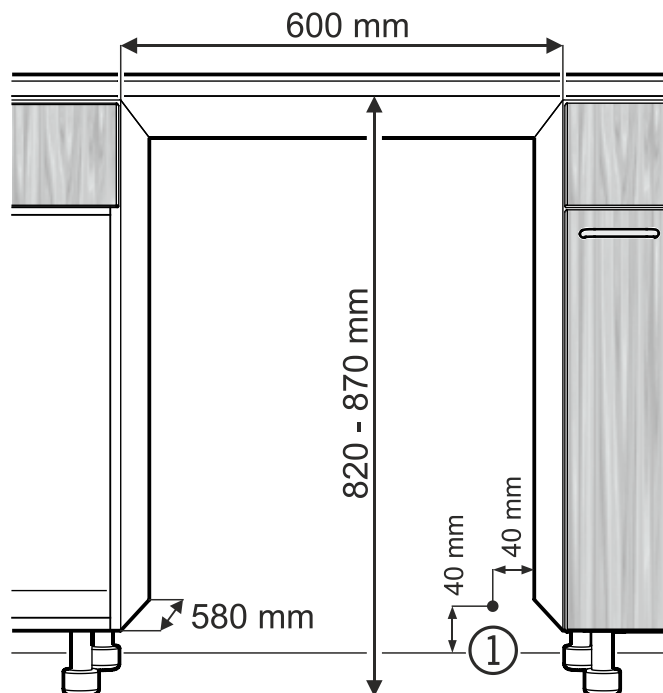

① In this area, the power cord comes out of the appliance rear.

Free length of the power cord = **2000 mm**

Choose the position of the socket considering these specifications.

The socket must not be situated behind the appliance and must be easily accessible.

Installing the appliance

- 1.**
Remove cover ①.

Apply the cover strips to the leading edge of the appliance housing on the left and right.

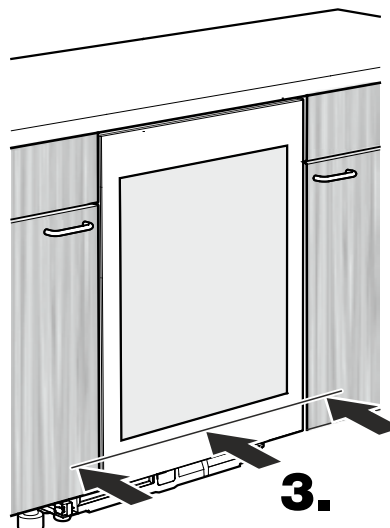
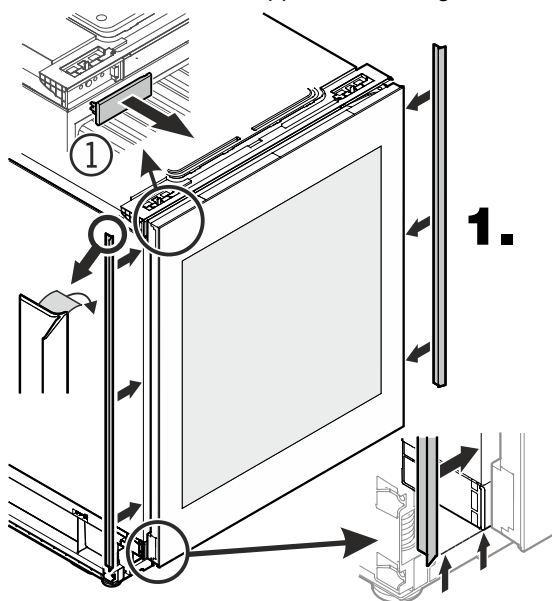

- 3.**
Slide in the appliance until the front surface of the appliance door is flush with the unit fronts.

When sliding in the appliance, make sure that the mains cable is not damaged!

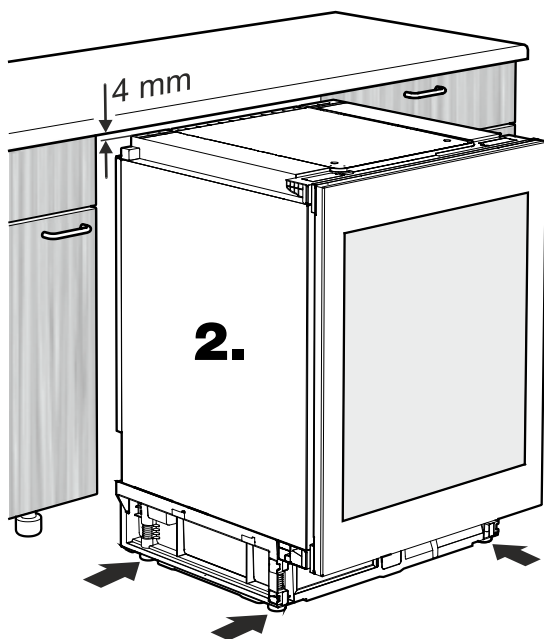

- 2.**
Adjust the height of the appliance to 4 mm less than the recess height by turning the adjustable feet clockwise.

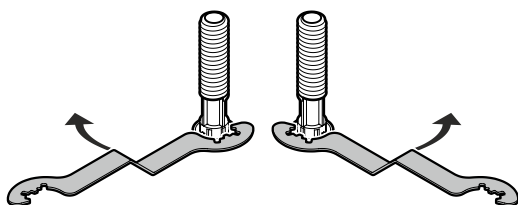

Turn the spanner anticlockwise to raise the appliance front and clockwise to lower it.

Position the spanner accordingly

Important

The appliance must be aligned horizontally and vertically. If the appliance is not level, the main body of the appliance can be deformed and the door will not close properly.

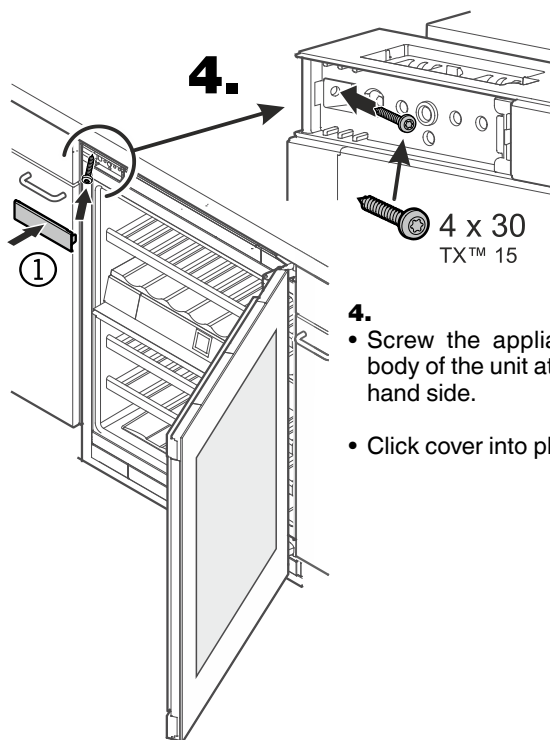

- 4.**
- Screw the appliance to the body of the unit at the top left-hand side.
 - Click cover into place again.

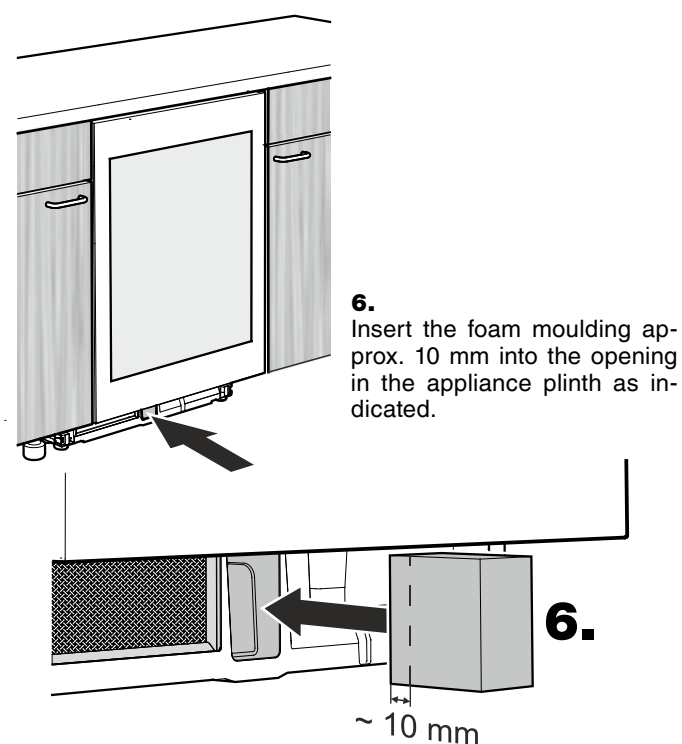
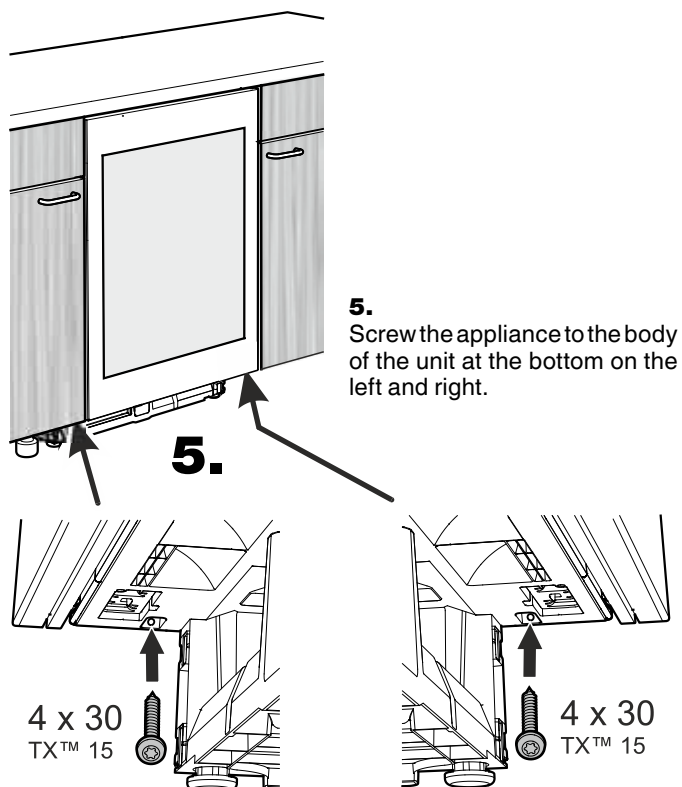

Important

If the foam moulding is not installed, the appliance will not achieve its full refrigeration performance during operation.

7. Insert the ventilation grille in the plinth panel.

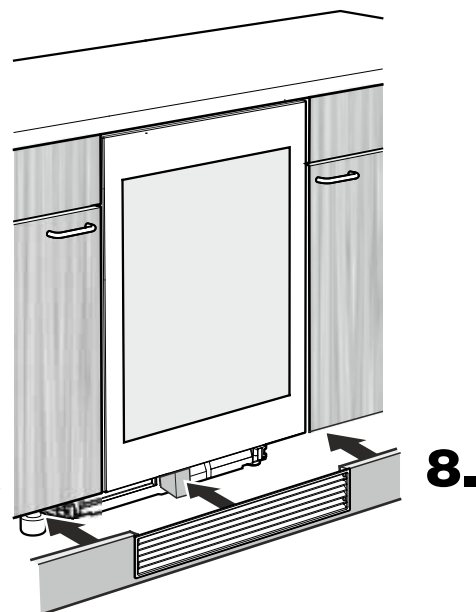
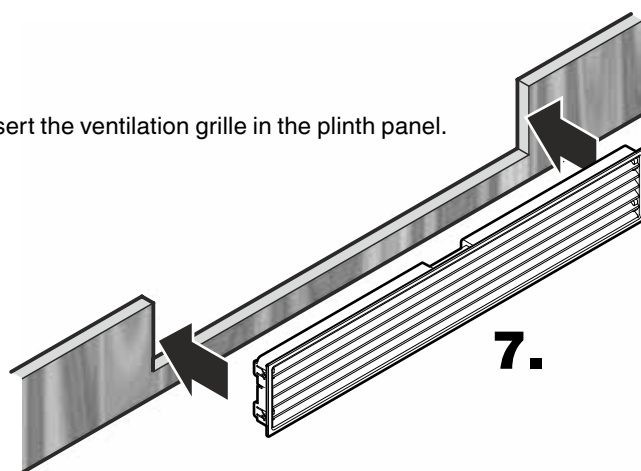

8. Fit the plinth panel. In doing so, the foam moulding is pushed backwards into its final position.

Important

The foam moulding must be touching the ventilation grille.

Changing over door hinges

Door hinges should only be changed by a trained expert.

Changing the door hinges must be done by two people.

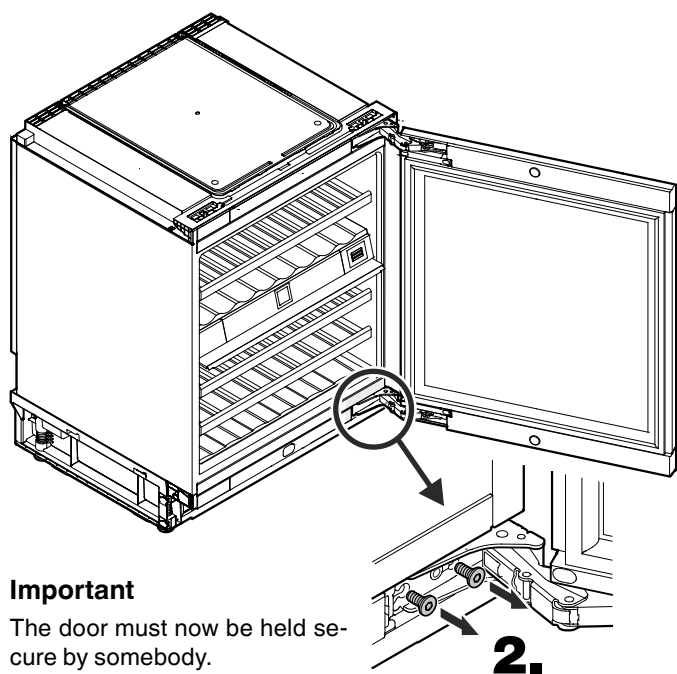
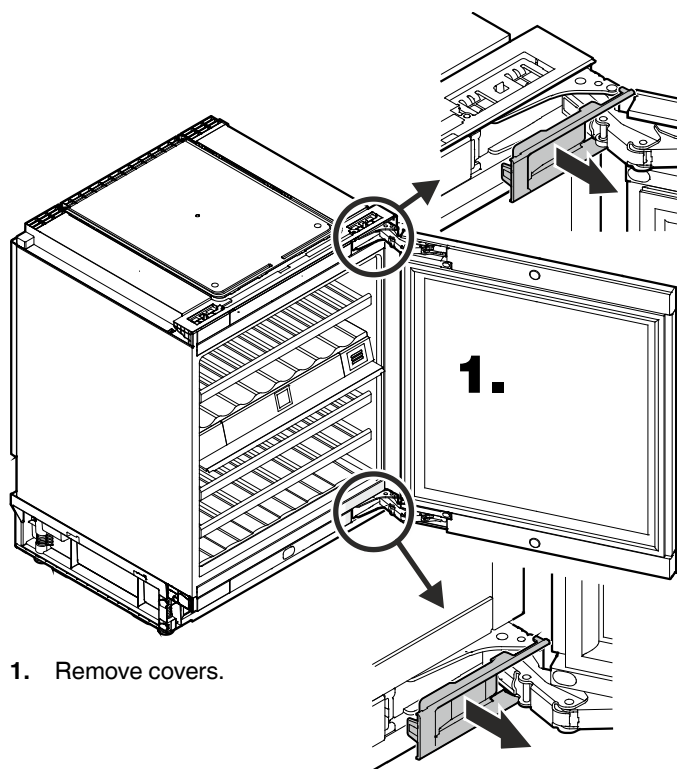

Important

The door must now be held secure by somebody.

2. Remove screws from lower hinge.

3. Remove screws from upper hinge.

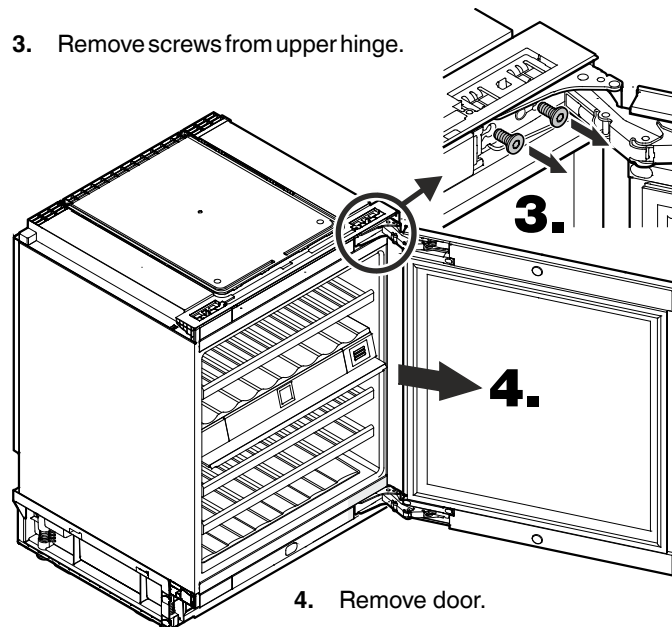

4. Remove door.

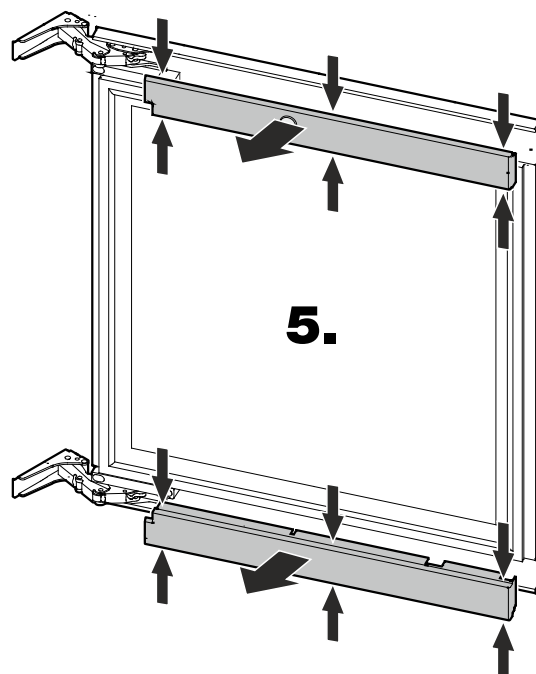

5. Compress the covers in the places shown, release and remove.

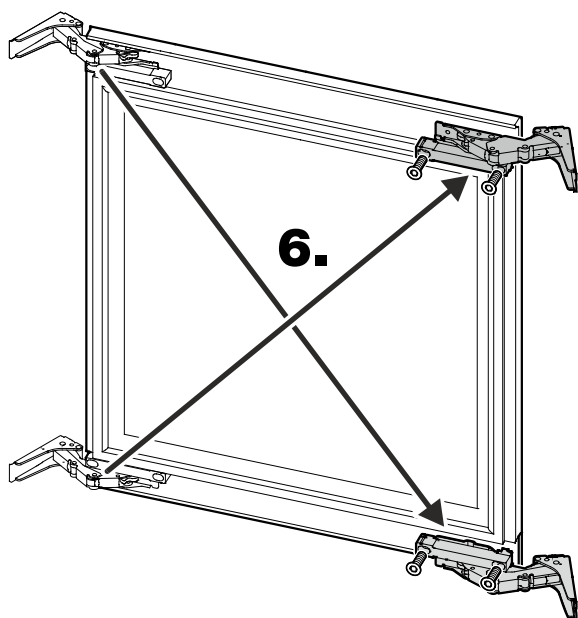

6. Unscrew hinges and re-fit on the opposite side at diagonals to the original position.

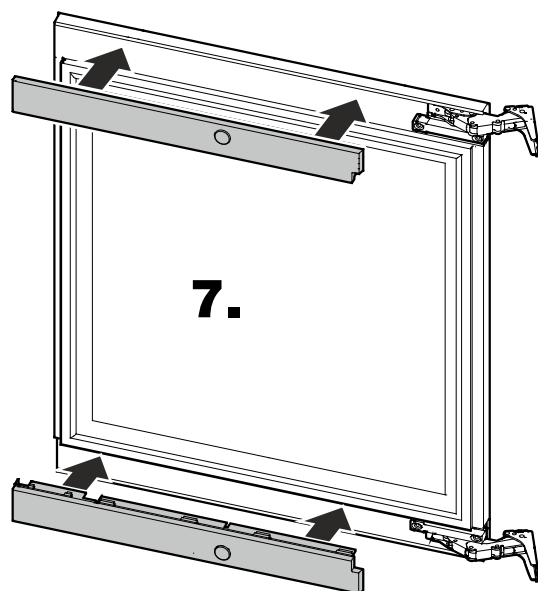

7. Fit covers and click into place.

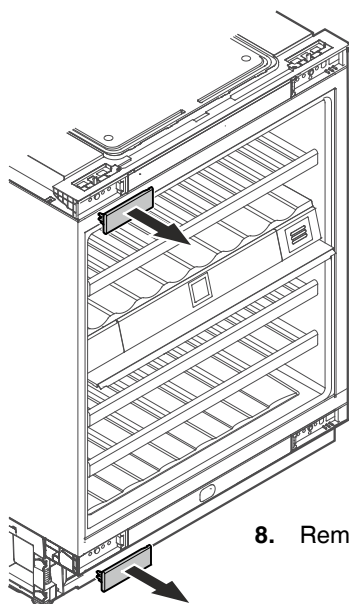

8. Remove the covers.

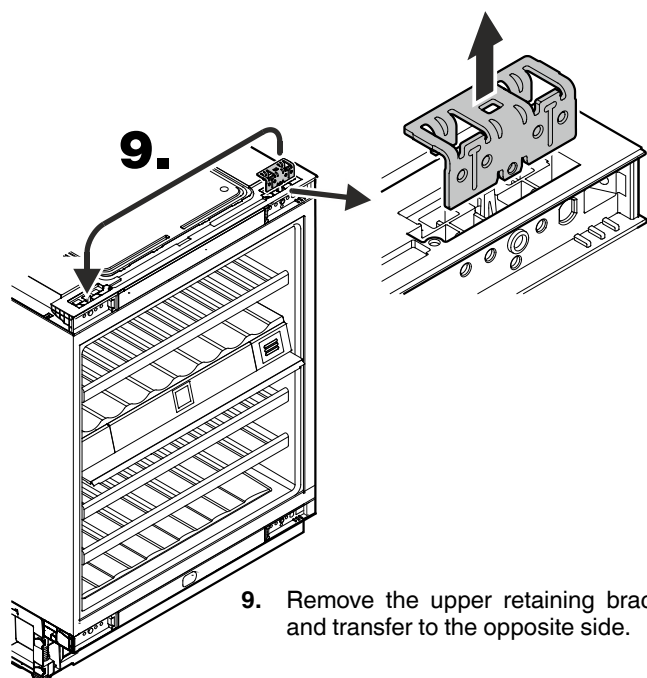

9. Remove the upper retaining bracket and transfer to the opposite side.

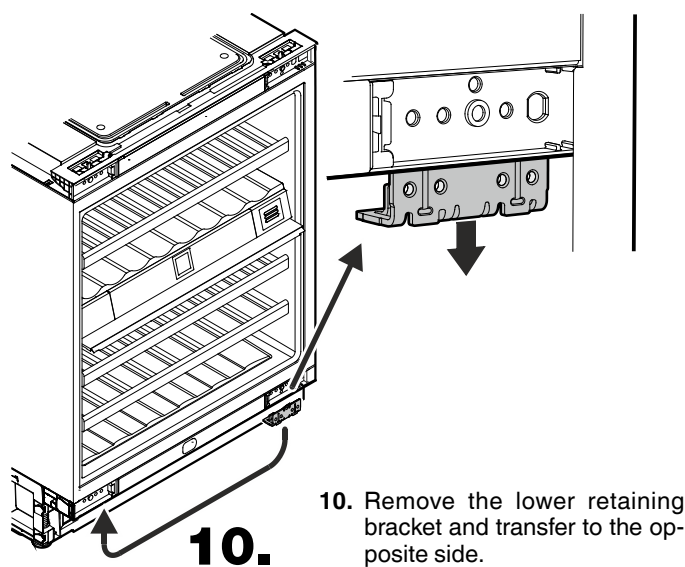

10. Remove the lower retaining bracket and transfer to the opposite side.

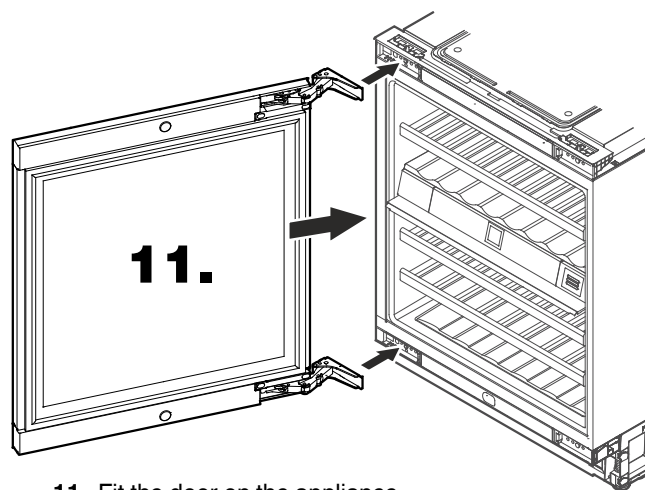

11. Fit the door on the appliance.

Important

The door must now be held secure by somebody.

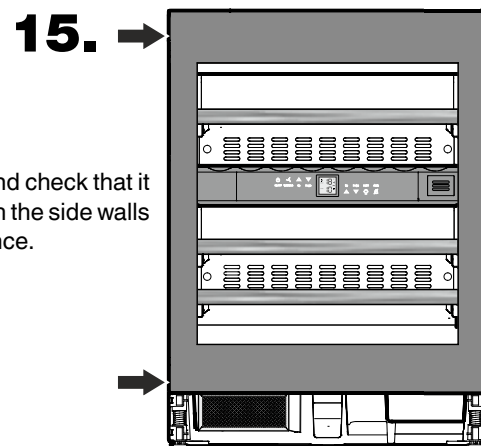
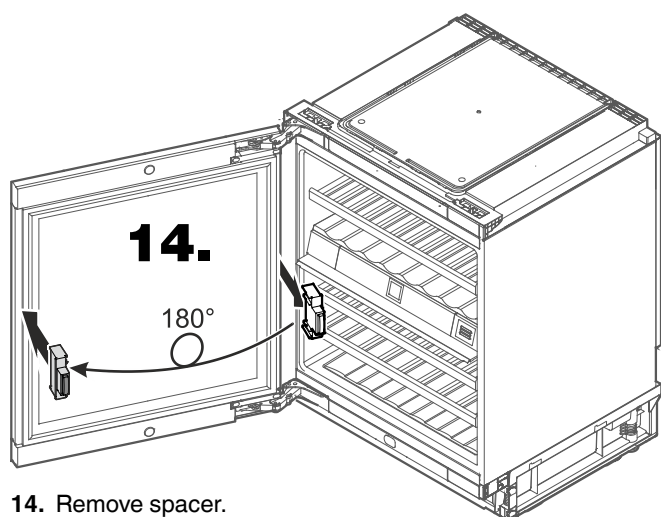
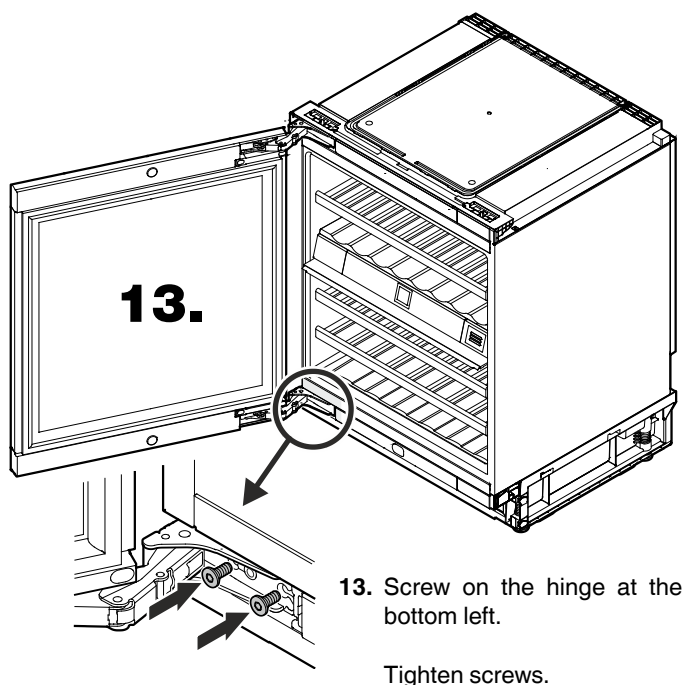
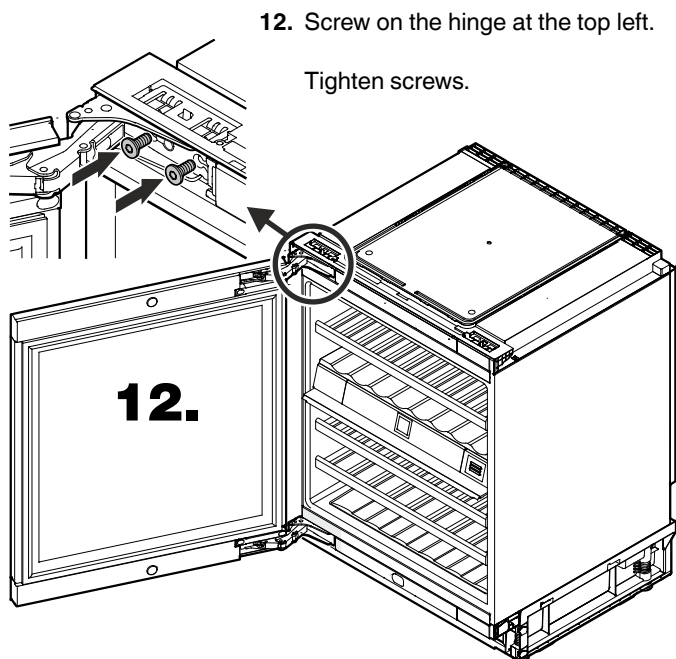

Adjusting the lateral tilt of the door
If the door is at an angle, adjust the angle.

